

STERLING

SAR 420SA Dust Extraction Systems



The Modular Extraction System is a flexible method of combining the correctly sized filter unit with either individual or multiple fans to suit specific applications. This makes it a far more effective machine than a traditional generic extractor. The wide selection of fans available with this system allows the designer to further tailor the system to their designed specification.

These filter units are fitted with properly tested and certified ATEX Explosion Relief and an Auto Shake Filter Cleaning System can be added to increase filter life. A full range of fans ranging from 0.55 kW through to 55 kW are available.

Other fans, such as high-pressure fans for high vacuum systems are also available. Modular Extractors can be fitted with multiple fans. This allows for a number of separate extraction operations to take place while feeding back to a common filtration and waste collection point. This includes the use of different fan types.

Our modular extractor range is fitted with tubular filters which allows them to be used with a wide variety of waste ranging from fine dust through to heavy, coarse waste. This makes them ideal for the wood working, metal working and plastic industries.

As standard these extractors are fitted with 350 gm Terylene needle felt filters. Other filters types and coatings such as oleophobic, hydrophobic, PTFE and PU type filters are all available upon request. 500 gm and single filament filters are also available. Modular Extractor filters are manufactured as spring cuff filters as standard, allowing for easy replacement during service. Heppa filters can be provided as an optional extra to offer an additional highly efficient layer of filtration.

The machines are proofed for use either outside or inside and are cladded with both anti vibration rubber and acoustic foam to ensure the machine is as quiet as possible. All this amounts to ensuring the end client is provided with a high quality, flexible product.

Modular Extractors are supplied as galvanised units as standard and powder coated. Any module can be fitted with a rotary valve and a steel frame to replace the traditional waste collection bins. This allows the end client to move over to their own waste collection systems or to use a transfer fan system. Backdraft dampers allow the use of multiple fans including fans with different static pressures.

Control panels are provided as standard with all Mardon Modular Extractors. However, additional features, such as temperature sensing, ATEX burst detectors and the remote stop starts can also be provided. Security panels can be added to enclose the base of the extractor for weather protection or security.

TECHNICAL SPECIFICATIONS

MODULE VARIANT	FILTER AREA
Mini Module	9.3 m ² (100 ft ²)
SME (Short Module)	13.4 m ² (144 ft ²)
SMEX (Extra Wide Short Module)	16.8 m ² (180 ft ²)
ME (Tall Module)	21 m ² (226 ft ²)
MEX (Extra Wide Tall Module)	26.2 m ² (282 ft ²)

Machine Features

- Modular design allowing great flexibility in design
- All ATEX as standard
- Units accept single or multiple fans with ease
- High quality finish and complete galvanised construction and powder coated

Optional Features

- Heppa Filters
- Additional Loc-Line Top Extraction
- Clean up hose kit
- Rotary valve and Steel Frame for Waste Collection integration
- Control Panel Add-Ons such as Temperature Sensors, ATEX burst detectors and remote start / stop
- Security panels for weather protection or added security
- Auto-shake filter for automated cleaning and extended filter life

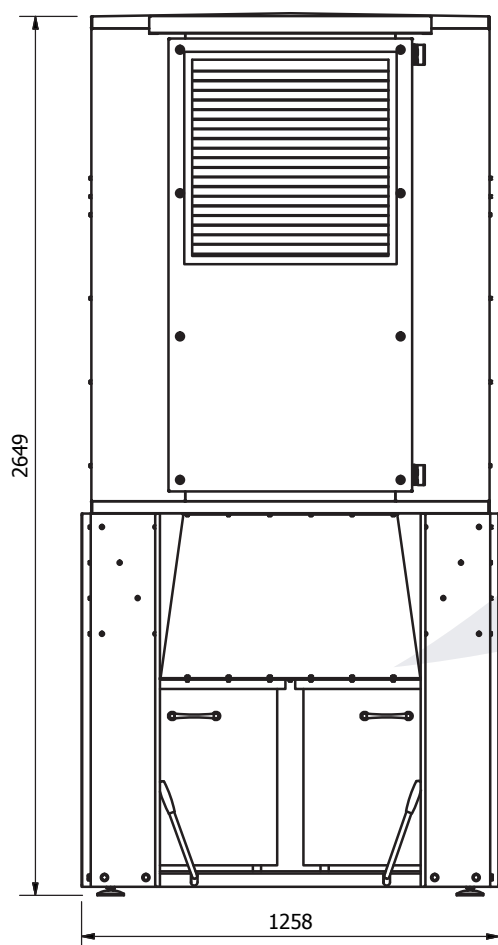

SMEX Module

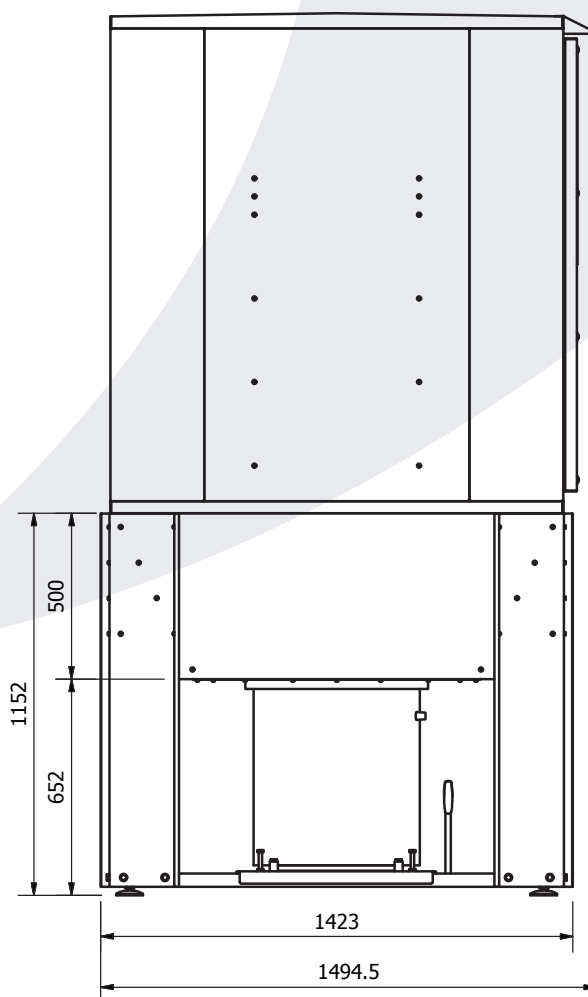

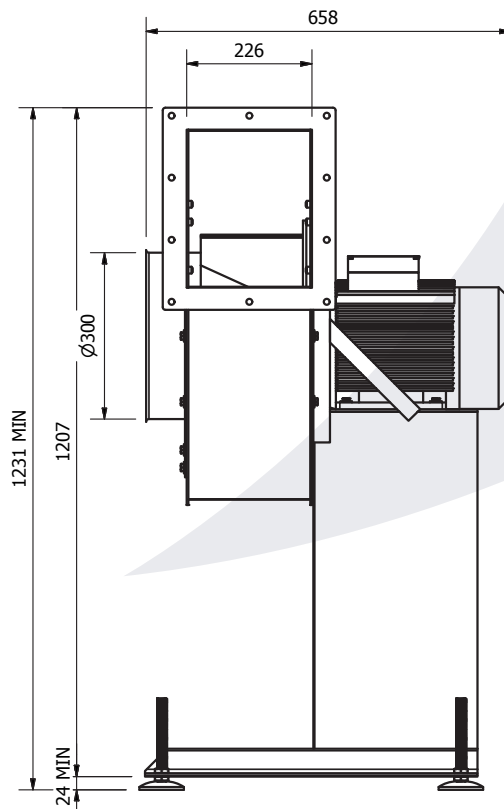
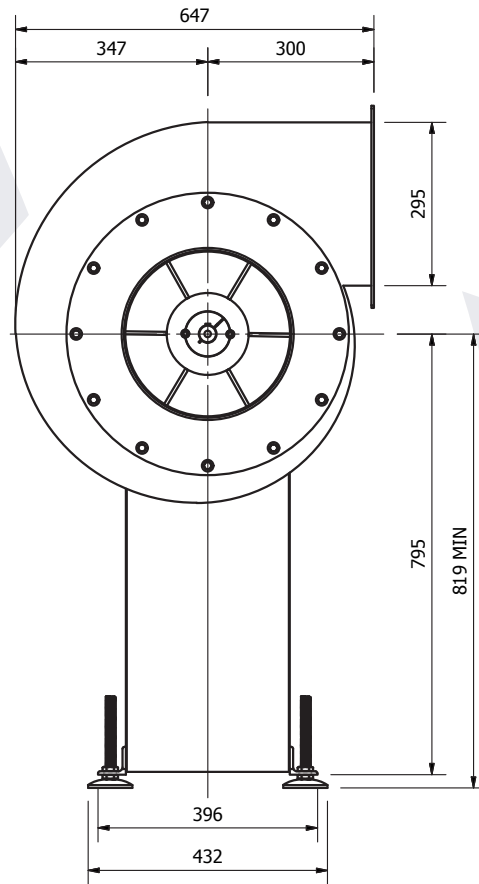

7.5kW Fan