



PBXS CNC Pressbrakes

The Morgan Rushworth PBXS CNC hydraulic press brakes are fitted with the ESA S875 CNC Control featuring a 21" touch screen and both numerical and 2D graphical program entry. While data input into the CNC Control is very rapid, there is also the option of preparing the production off line on a PC with the software provided, enabling feasibility checks prior to production.



All axes are fully synchronised and accurate 0.01mm utilising proportional valve technology. Monoblock welded steel frame ensures minimum deflection under maximum load.

The range covers models from 40 tonnes through to 1000 tonnes capacity with bending lengths from 1250mm up to 8100mm in the standard design.

A comprehensive range of options are available to fully tailor the machine to requirements.

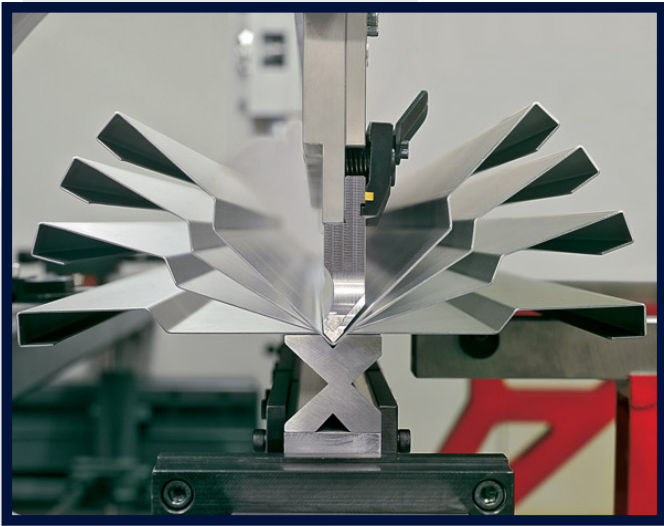

**MORGAN RUSHWORTH
PRECISION BENDING**

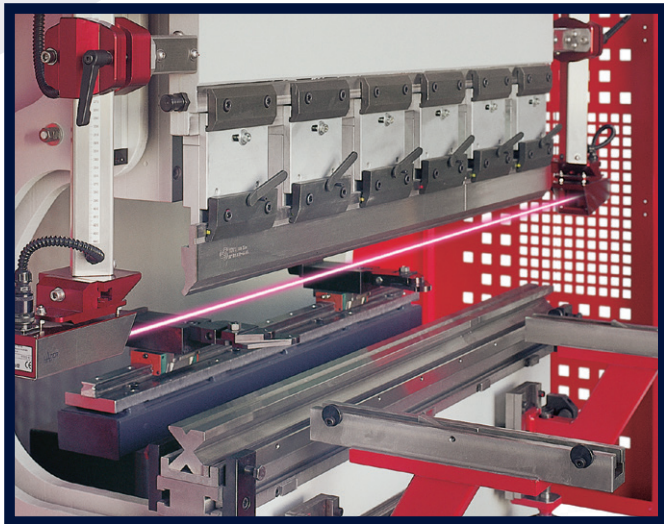

FRONT LASER PROTECTION SYSTEM



REAR VIEW

Machine Features

- ESA S875 multi-axis CNC control with numerical and 2D graphical programming and 2D or 3D visualisation, mounted on pendant arm
- Ideal for complex multi bending operations, especially where volume production with accurate repeatability is required
- Fully synchronised CNC control for left and right upper beam cylinder position - Y1 + Y2 axis
- CNC control for backgauge depth - X axis
- Manual adjustment of backgauge height - R axis
- Manual side to side adjustment of backgauge fingers - Z axis
- AKAS laser tooling guards for enhanced ease of use
- Euro style quick release top tool holders with intermediate pieces including wedges for crowning
- Sectionalised goose neck top tool and multi vee bottom die
- Strong rigid welded mono block frame able to withstand deflection under maximum load
- High precision linear scales for measurement of stroke depth mounted on side frames rather than top beam to prevent any distortion in accuracy as beam comes under load
- Hydraulic ram travel guided in low friction slideways
- Large open height and generous ram stroke
- Deep reinforced throat in side frames
- High approach and return speeds for production bending
- Front support arms with flip stop, adjustable on a linear rail
- Dual foot switch console with emergency stop
- Electrically interlocked side guards
- Electrically interlocked rear access door

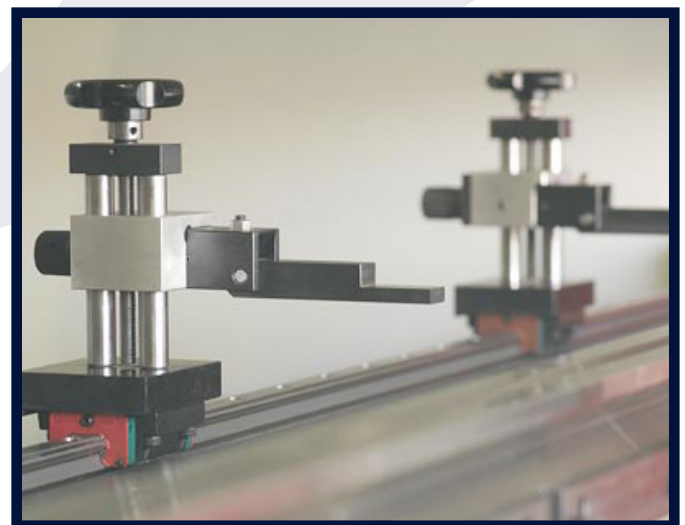

BACK GAUGE FINGERS



CNC CONTROLLED BOTTOM TOOL CROWNING SYSTEM (OPTIONAL)

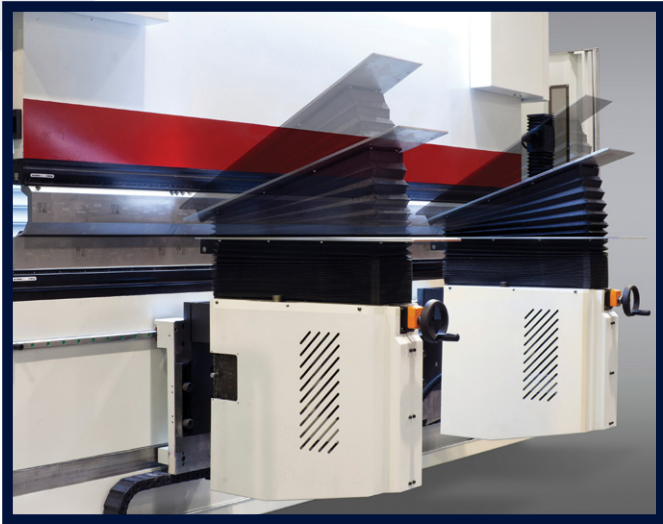

SHEET FOLLOWER SUPPORT ARMS (OPTIONAL)

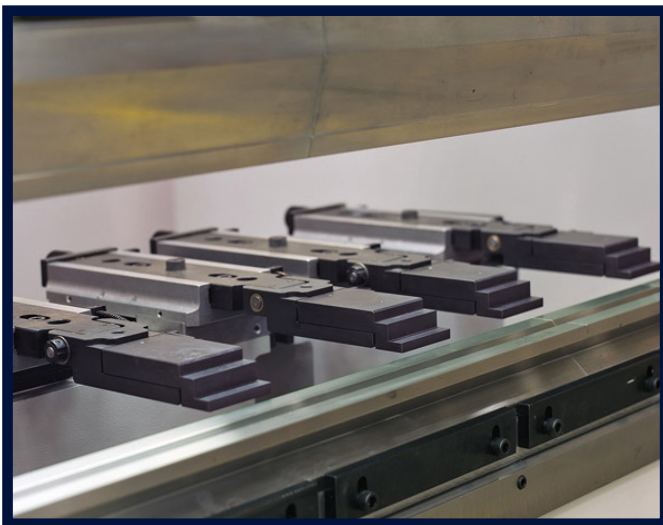

ADDITIONAL BACKGAUGE FINGERS (OPTIONAL)

Optional Equipment

- Cybelec ModEva 12S 3D graphical CNC control
- Cybelec ModEva 15S 3D graphical touchscreen CNC control
- Delem DA66T 2D graphical touchscreen CNC control
- Delem DA69T 3D graphical touchscreen CNC control
- CNC control for backgauge height - R axis
- Independent CNC control for backgauge height - R1 + R2 axis
- CNC control for side to side movement of backgauge fingers - Z1 + Z2 axis
- Independent CNC control of backgauge depth - X1 + X2 axis
- Independent CNC tower backgauge system - X1 + R1 + Z1, X2 + R2 + Z2
- Manual bottom tool crowning system
- CNC controlled bottom tool crowning system
- Hydraulic top and bottom tooling clamping system
- Additional backgauge fingers
- Additional front support arms
- Brush table for front support arms
- Sheet follower support arms controlled by the CNC Controller
- Parking area for sheet follower support arms - one per side
- Laser Angle Measuring System



DELEM DA66T CONTROL (OPTIONAL)



DELEM DA69T CNC CONTROL (OPTIONAL)



HYDRAULIC TOOL CLAMPING (OPTIONAL)



FRONT SUPPORT ARMS

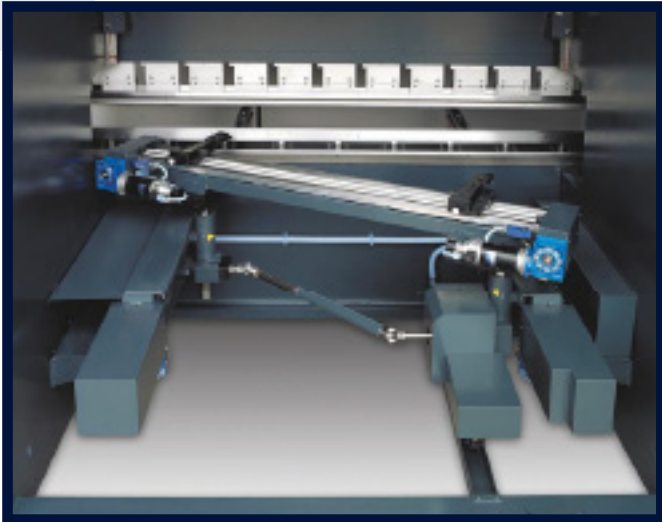

X1+X2, R1+R2, Z1+Z2 CNC BACKGAUGE (OPTIONAL)



INDEPENDENT TOWER BACKGAUGE (OPTIONAL)

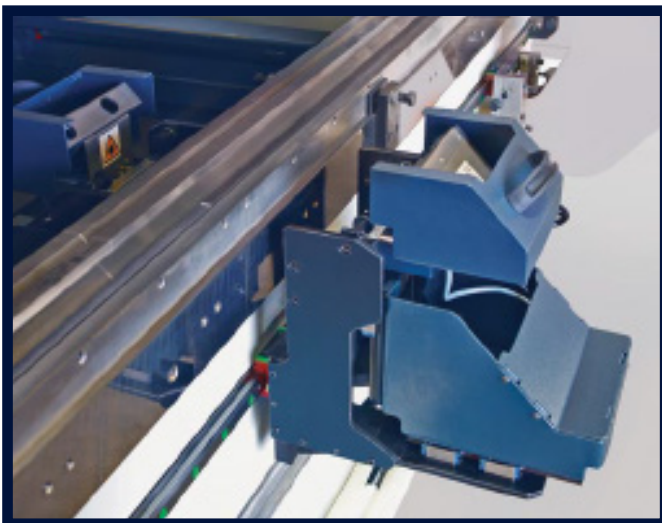

LASER ANGLE MEASUREMENT SYSTEM (OPTIONAL)



MULTI-VEE BOTTOM TOOLING

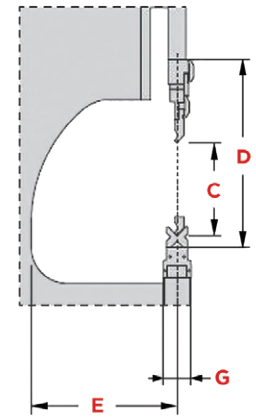
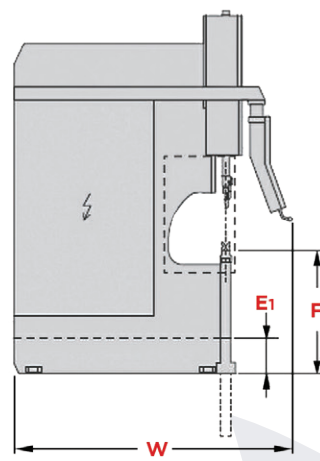
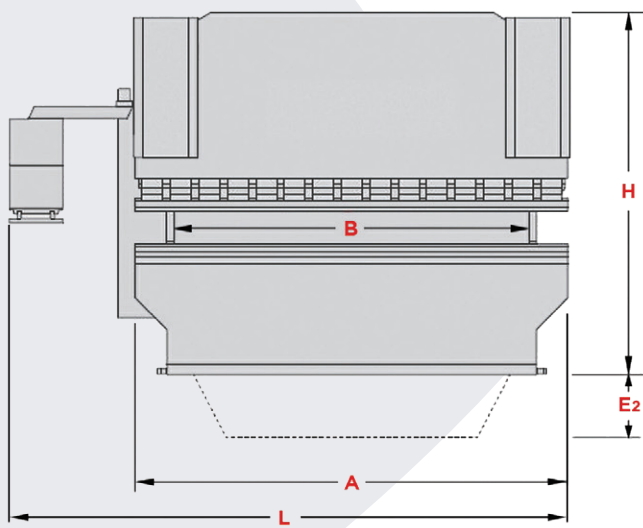

TECHNICAL SPECIFICATIONS

MODEL	STOCK CODE	BENDING POWER	BENDING LENGTH	DIST. BETWEEN COLUMN	Y RAPID SPEED	Y WORKING SPEED	Y RETURN SPEED	TRAVEL IN X AXIS	SPEED OF Y AXIS	TRAVEL IN R AXIS (OPTIONAL)	SPEED OF R AXIS (OPTIONAL)	NUMBER OF BACKGUAGE FINGERS	NUMBER OF SHEET SUPPORT ARMS	OIL CAPACITY	MOTOR POWER	STROKE	DAYLIGHT	THROAT DEPTH	TABLE HEIGHT	TABLE WIDTH	PIT DEPTH 1	PIT DEPTH 2	LENGTH	WIDTH	HEIGHT	WEIGHT
		Tonne	A mm	B mm	mm/sec	mm/sec	mm/sec	mm	mm/sec	mm	mm/sec	mm/sec	mm	mm	Litre	kW	C mm	D mm	E mm	F mm	G mm	E1 mm	E2 mm	L mm	W mm	H mm
PBXS 1250/40	M5200	40	1250	1070	160	10	130	1000	350	160	240	2	2	80	8	215	455	410	800	60	-	-	3000	2670	2250	3300
PBXS 2100/60	M5201	60	2100	1600	150	10	130	1000	350	160	240	2	2	140	9.5	210	475	410	880	60	-	-	3850	2780	2542	5400
PBXS 2600/60	M5202	60	2600	2050	160	10	130	1000	350	160	240	2	2	140	9.5	210	475	410	880	60	-	-	4350	2780	2542	6200
PBXS 2600/90	M5203	90	2600	2050	150	10	130	1000	350	160	240	2	2	140	11.5	260	540	410	880	60	-	-	4350	2780	2605	7100
PBXS 3100/90	M5204	90	3100	2550	160	10	130	1000	350	160	240	2	2	140	11.5	260	530	410	880	60	-	-	4850	2790	2605	7900
PBXS 3100/120	M5205	120	3100	2550	160	10	130	1000	350	160	240	2	2	140	15	260	540	410	880	60	-	-	4850	2790	2905	8400
PBXS 3100/160	M5206	160	3100	2550	160	10	130	1000	350	160	240	2	2	210	19	260	540	410	880	60	-	-	4850	2800	2905	9700
PBXS 3100/200	M5207	200	3100	2550	150	10	130	1000	350	160	240	2	2	210	22.5	260	530	410	880	90	-	-	4850	2800	2905	10000
PBXS 3100/240	M5208	240	3100	2550	130	10	120	1000	350	160	240	2	2	210	26	260	530	410	880	90	-	-	4850	2810	2905	11000
PBXS 3100/300	M5209	300	3100	2550	110	8	100	1000	350	160	240	2	2	280	26	320	660	500	905	380	-	-	4850	3015	3150	15000
PBXS 3100/440	M5256	440	3100	2550	80	8	70	1000	350	160	240	2	2	450	34	320	575	500	1005	450	-	-	4850	3260	3400	22000
PBXS 3700/120	M5210	120	3700	3250	170	10	130	1000	350	160	240	2	2	210	15	260	530	410	870	60	-	-	5450	2830	2905	9400
PBXS 3700/160	M5211	160	3700	3250	170	10	130	1000	350	160	240	2	2	210	19	260	530	410	880	60	-	-	5450	2800	2905	10700
PBXS 3700/200	M5212	200	3700	3250	150	10	130	1000	350	160	240	2	2	210	22.5	260	530	410	880	90	-	-	5450	2800	2905	11200
PBXS 3700/240	M5213	240	3700	3250	140	10	120	1000	350	160	240	2	2	210	26	260	530	410	880	90	-	-	5450	2810	2905	13500
PBXS 3700/300	M5214	300	3700	3250	120	8	110	1000	350	160	240	2	2	280	26	320	635	500	980	280	-	-	5450	3020	3200	17000
PBXS 4100/160	M5215	160	4100	3550	170	10	100	1000	350	160	240	4	2	210	19	260	530	410	880	60	-	-	5850	2800	2905	12000
PBXS 4100/200	M5216	200	4100	3550	160	10	110	1000	350	160	240	4	2	210	22.5	260	530	410	880	90	-	-	5850	2800	2905	12500
PBXS 4100/240	M5217	240	4100	3550	150	10	100	1000	350	160	240	4	2	210	26	260	530	410	880	90	-	-	5850	2810	2905	14000
PBXS 4100/300	M5218	300	4100	3550	120	8	90	1000	350	160	240	4	2	280	26	320	635	500	980	280	-	-	5850	3020	3200	18500
PBXS 4100/440	M5219	440	4100	3550	80	8	70	1000	350	160	240	4	2	450	34	320	590	500	955	380	-	-	5850	3435	3350	26000
PBXS 6100/160	M5220	160	6100	5100	140	10	100	1000	350	160	240	4	4	240	19	260	510	500	1000	90	-	-	7850	3160	2850	20000
PBXS 6100/240	M5221	240	6100	5100	140	10	100	1000	350	160	240	4	4	300	26	260	500	500	1100	90	-	-	7850	3160	3000	25000
PBXS 6100/300	M5222	300	6100	5100	120	8	70	1000	350	160	240	4	4	300	26	320	560	500	1115	200	-	-	7850	3260	3280	30000
PBXS 6100/380	M5223	380	6100	5100	90	8	70	1000	350	160	240	4	4	450	34	320	570	500	1100	240	-	-	7850	3410	3255	35000
PBXS 6100/440	M5224	440	6100	5100	90	8	70	1000	350	160	240	4	4	450	34	320	570	500	1100	280	-	-	7850	3450	3700	39000
PBXS 6100/500	M5225	500	6100	5100	80	8	70	1000	350	160	240	4	4	450	41	340	530	500	815	380	250	800	7850	3550	3500	48000
PBXS 6100/600	M5226	600	6100	5100	80	7	70	1000	350	160	240	4	4	500	41	360	620	500	1050	380	370	1150	7850	3600	4100	55000
PBXS 6100/800	M5255	800	6100	5100	70	6	60	1000	350	160	240	4	4	700	49	500	750	750	1050	500	600	1200	7850	4000	4750	70000
PBXS 6100/1000	M5257	1000	6100	5100	70	6	60	1000	350	160	240	4	4	860	59	500	750	750	800	500	700	1500	7850	4100	4900	80000
PBXS 8100/1000	M5258	1000	8100	6050	70	5	60	1000	350	160	240	4	4	860	59	500	750	750	800	500	700	1900	9850	4200	5000	95000