

# SELMACH™

MACHINERY



TOOLING & CONSUMABLES CATALOGUE

## PUNCH & DIE SPECIFICATION

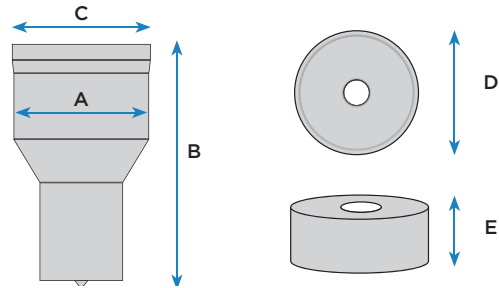

PUNCH DIMENSIONS		A Maximum OD	B Punch Length	C Top Width
Under 100T		38	61.5	35
 Over 100T		45	78	45
DIE DIMENSIONS		D Diameter of Die	E Thickness of Die	
Under 100T		61.5	32	
Over 100T		78	40	

PUNCH DIMENSIONS		A Maximum OD	B Punch Length	C Top Width
 Geka 5		27	53	30.4
Geka 8		31	64	34.8
Geka 8/40		40	64	43.8
Geka 10		40	73	43.8
DIE DIMENSIONS		D Diameter of Die	E Thickness of Die	
Geka 5		50.8	25.5	
Geka 8		59.8	32	
Geka 8/40		59.8	32	
Geka 10		72.8	32	

MODEL	GEKA 5		GEKA 8		GEKA 8/40		GEKA 10	
	P	D	P	D	P	D	P	D
Microcrop	●	●						
Minicrop	●	●						
Multicrop	●	●						
PP50	●	●						
Geka/Puma 50	●	●						
Geka/Puma 55		●	●	●	●	●		
Geka/Puma 70	●	●						
Geka/Puma 80		●	●	●	●	●		
Geka/Puma 100			●	●				
Geka 110		●	●		●			●
Geka/Puma 150							●	●
Geka 165							●	●



Selmach's series of punches & dies are produced to exacting standards and are suitable for all types of steelworkers and punching machines. Proven manufacturing techniques and a closely controlled heat treatment process guarantees optimum punching performance. In addition to the comprehensive range of standard stock products, Selmach offers oversize tooling and design solutions for virtually any application.

**Punches with Shear Angle for Stainless Steel available on request.**

**NEXT DAY  
DELIVERY**

**Morgan Rushworth/Kingsland**

To fit machines up to 95 tonnes

Round	Punch	Die	Offset Die
Up to 31mm	12001	12501	12513
32-38mm	12002	12501	12513
39-57mm	12003	12502	12514
58-85mm	12004	12503	12515
86-110mm	12005	12504	12516

To fit machines up to 95 tonnes

Slot	Punch	Die	Offset A	Offset B
Up to 31mm	12006	12505	12517	12521
31-38mm	12007	12505	12517	12521
39-57mm	12008	12506	12518	12522
58-85mm	12009	12507	12519	12523
86-110mm	12010	12508	12520	12524

To fit machines up to 95 tonnes

Square	Punch	Die	Offset Die
Up to 21mm	12011	12509	12531
22-26mm	12012	12509	12531
27-40mm	12013	12510	12532
41-60mm	12014	12511	12533
61-77mm	12015	12512	12534

To fit machines 100 tonnes and above

Round	Punch	Die	Offset Die
Up to 38mm	12016	12501	12513
39-57mm	12099	12502	12514

**Morgan Rushworth/Kingsland**

To fit machines up to 100 tonnes and above

Slot	Punch	Die	Offset A	Offset B
Up to 38mm	12017	12505	12517	12521
39-57mm	12100	12506	12518	12522

Square	Punch	Die	Offset Die
Up to 26mm	12018	12509	12531
27-40mm	12101	12510	12532



Geka

Round	Punch	Die	Offset Die
G5 up to 27mm	12019	12543	12567
G5 up to 28mm	12020	12544	12568
G8 up to 30mm	12105	12545	12570
G8/40 up to 40mm	12021	12545	12570
G10 up to 40mm	12022	12547	12571
G10 up to 50mm	12023	12548	12572
G10 up to 75mm	12024	12549	12573
G10 up to 100mm	12025	12550	12574

**CALL TODAY TO DISCOVER THE LARGE RANGE HELD IN STOCK  
TO ORDER: QUOTE STOCK CODE + DIAMETER REQUIRED**

## PUNCHES & DIES - Geka, Mubea, Promotech, Imac, Selfer, Alfra

### Geka CONT.

Slot	Punch	Die	Stock Code	
			Offset A	Offset B
G5 up to 27mm	12026	12551	12575	12583
G6 up to 28mm	12027	12552	12576	12584
G8 up to 30mm	12028	12553	12577	12585
G8/40 up to 40mm	12029	12553	12577	12585
G10 up to 40mm	12030	12555	12579	12587
G11 up to 50mm	12031	12556	12580	12588
G12 up to 75mm	12032	12557	12581	12589
G13 up to 100mm	12033	12558	12582	12590

Square	Punch	Die	Offset Die
G6 up to 19mm	12035	12560	12651
G8 up to 22mm	12036	12561	12652
G8/40 up to 28mm	12037	12561	12652
G10 up to 28mm	12038	12563	12654
G11 up to 35mm	12039	12564	12655
G12 up to 53mm	12040	12565	12656
G13 up to 70mm	12041	12566	12657

### Mubea

Round	Punch	Die
Mubea No.2	12075	12624
Mubea No.3	12078	12603
Mubea No.4	12081	12629

Slot	Punch	Die
Mubea No.2	12076	12625
Mubea No.3	12079	12627
Mubea No.4	12082	12630

### Promotech

Round	Punch	Die

Slot	Punch	Die

### Imac, Selfer & Alfra

Round	Punch	Die

Slot	Punch	Die

Square	Punch	Die

### Piranha

Round	Punch	Die
P70/90	12063	12658

Slot	Punch	Die
P70/90	12064	12611

Square	Punch	Die
P70/90	12065	12612

### Edwards

Round	Punch	Die

Slot	Punch	Die

Square	Punch	Die

- To order, state the relevant stock code followed by size required eg: 14mm x 27mm slot punch for Geka 5 - 12026-14 x 27
- Large stocks available for same day/next day delivery
- Any special sizes can be manufactured upon request within 3 to 5 days